

# MXN Filter

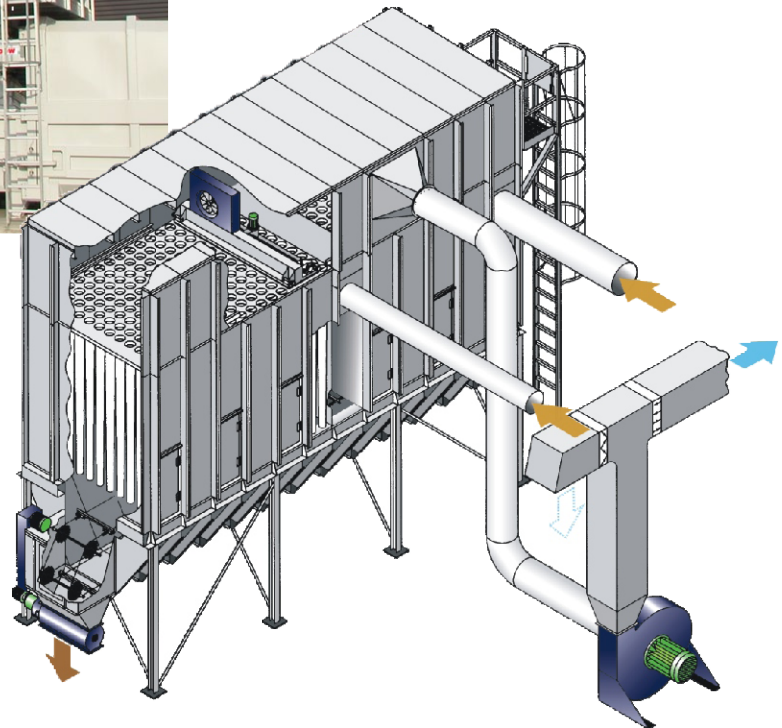
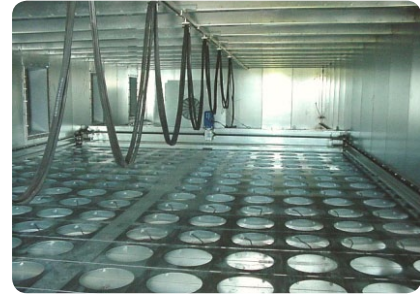

Moldow MXN filter is for negative pressure and designed with automatic and continuous high pressure cleaning of the filter media. The filter design and high pressure cleaning permits considerably higher loads compared to traditional filters.

## High load – highly competitive

Moldow MX filters are designed for air volumes between approx. 20,000-200,000 m<sup>3</sup>/h, where continuous operation up to 24 hours, 7 days a week is required. The filters are designed to operate in systems with a pressure difference of max. 5,000 Pa. The filter bags (with dust settling on the outside) are fitted with an inner spring bracing. The special bag design reduces the air velocity, which increases the air and dust load considerably.

## Regeneration efficiency

The filter bags are cleaned continuously during operation by use of a regeneration carriage with a high-pressure fan that sends air from the clean-air chamber back through the filter bags using nozzle pipes. This is a very efficient way of cleaning the bags, and therefore, a load up to 200 m<sup>3</sup> air per m<sup>2</sup> filter area per hour can be reached, depending on the system and dust load.

## Energy savings

The MXN filter is designed for negative operation which allows the use of high efficient clean air fans. Considerable energy savings are reached when combined with Moldow industrial fans with an efficiency of 90%.

### Advantages:

- High capacity (150 - 200 m<sup>3</sup>/m<sup>2</sup>/h)
- Efficient filtration
- Minimum dust emission
- Continuous operation 24/7
- Particularly suitable for negative pressure systems

# MXN Filter

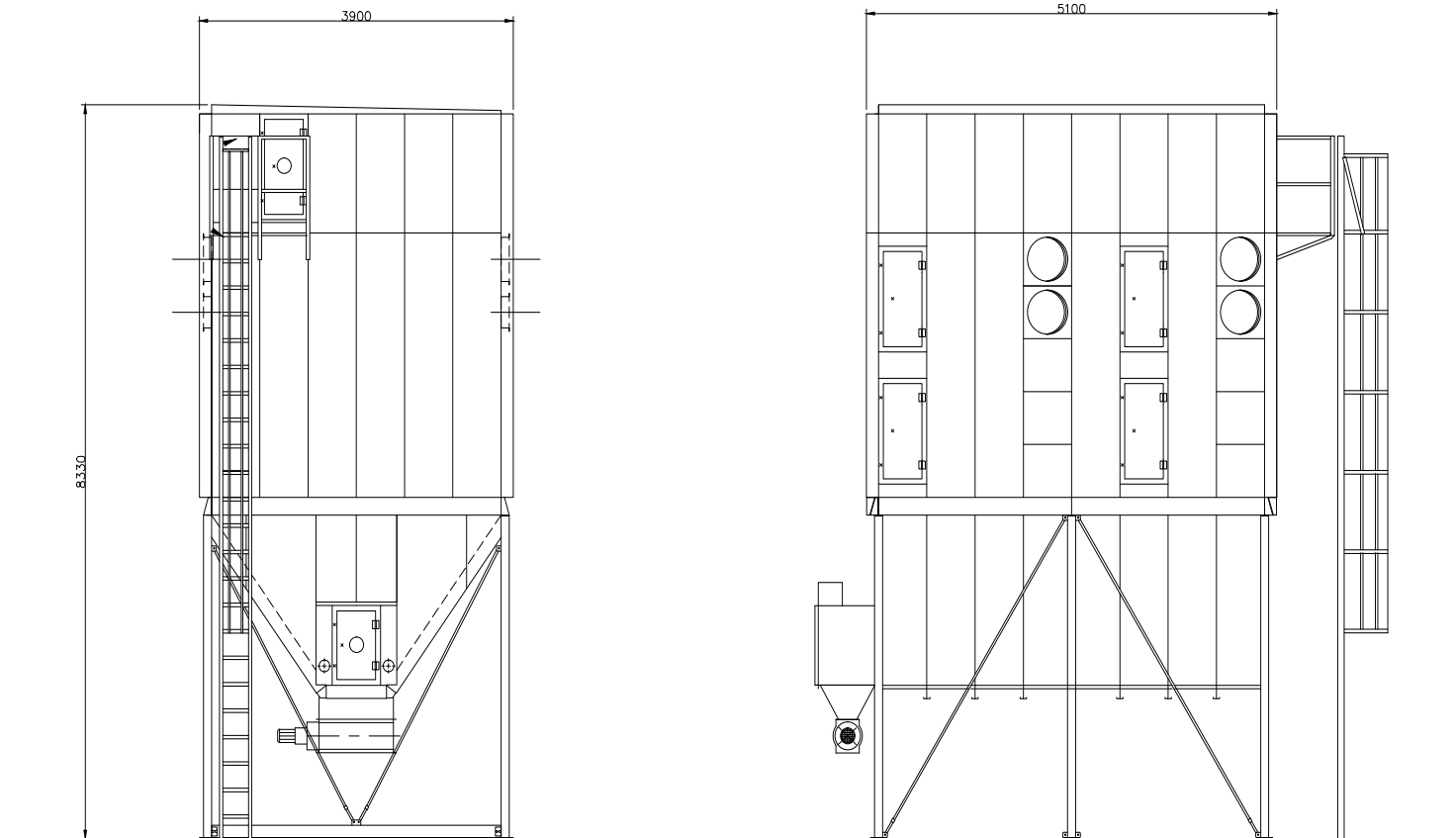

TYPE	FILTER SECTIONS	INLET SECTIONS	LENGTH	FILTER AREA	
			mm	m <sup>2</sup>	sq ft
062 MXN-324	6	2	4800	264	3100
082 MXN-324	8	2	6000	360	4133
102 MXN-324	10	2	7200	456	5167
103 MXN-324	10	3	7800	456	5167
122 MXN-324	12	2	9000	552	6200
123 MXN-324	12	3	9000	552	6200
142 MXN-324	14	2	9600	648	7233
143 MXN-324	14	3	10200	648	7233
144 MXN-324	14	4	10800	648	7233
162 MXN-324	16	2	10800	744	8266
163 MXN-324	16	3	11400	744	8233
164 MXN-324	16	4	12000	744	8266
182 MXN-324	18	2	12000	840	9300
183 MXN-324	18	3	12600	840	9300
184 MXN-324	18	4	13200	840	9300
202 MXN-324	20	2	13200	936	10333
203 MXN-324	20	3	13800	936	10333
204 MXN-324	20	4	14400	936	10333
205 MXN-324	20	2	15000	936	10333
223 MXN-324	22	3	15000	1032	11367
224 MXN-324	22	4	15600	1032	11367
225 MXN-324	22	5	16200	1032	11367

## Concept

For systems where the collected waste has to be transported to a storage silo or to a waste container, some a mechanical conveyor, drag link or screw is fitted to the base of the filter with final material discharge through a rotary valve. In plants where a pressurized silo is acceptable, the MXN can be mounted directly on to the silo and used as an automatically cleaned venting filter. MX filters can be applied to the majority of exhaust systems and can be constructed of, or lined with, special material with bags manufactured from any of the natural or synthetic fibres. Moldow's engineers and laboratory will be pleased to conduct tests and advise on the most appropriate solution to your problem.

### Standard delivery includes:

- Water outlet
- Polyester filter bags with springs
- Rotary valve with connecting piece
- Regeneration carriage with 4 kW fan motor
- Ladder and 1.2 m landing for access to regeneration cabinet

### Capacity

Air volume	30,000-265,000 m <sup>3</sup> /h
Material volume	0-20 m <sup>3</sup> /h